

LEMONAID UPCYCLING - DIY SOAP DISPENSER

DURATION: 2 MIN · DEGREE OF DIFFICULTY: VERY EASY

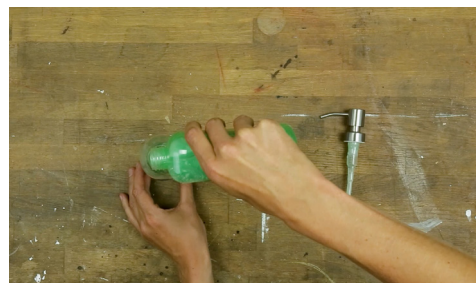

1. You need a Lemonaid bottle and an ugly soap dispenser



2. Unscrew the pump head and put the soap into the Lemonaid bottle.

EQUIPMENT:

- Lemonaid Bottle
- Ugly Soap Dispenser
- that's it!

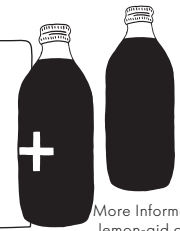

More Information:
lemon-aid.de/diy



3. Screw the pump head onto the Lemonaid bottle
– done!